

Valley Tech Approved Installation Method For Use At Brick Siding To Deck Interface

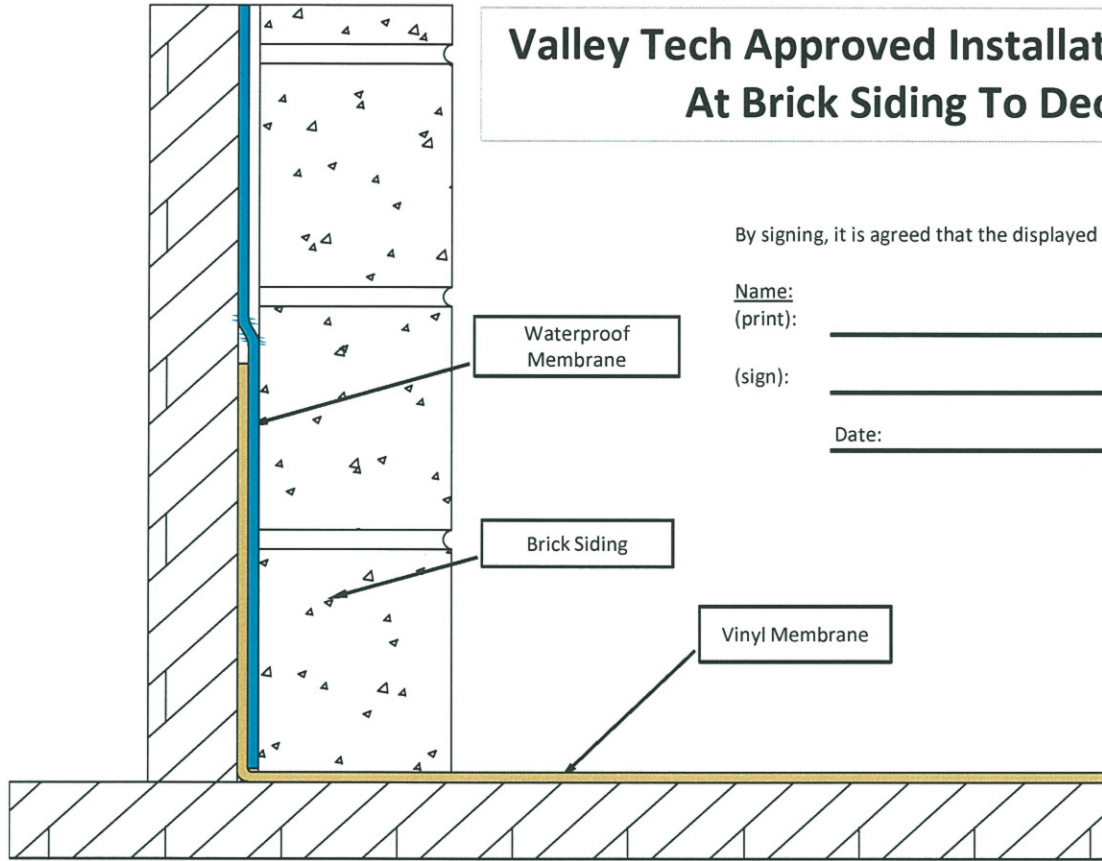

By signing, it is agreed that the displayed procedure will be performed as requested

Name: _____ Employee Witness: _____
 (print): _____ (print): _____
 (sign): _____ (sign): _____
 Date: _____



Vinyl spec. W/Install Beforehand
 Date: Oct 12, 10 Drawn by: Kevin DiMarco
 Created under RailPro Inc.
 Created for Internal purpose
 Notes:

RAILPRO Approved Installation Method For Use At Brick Siding To Deck Interface

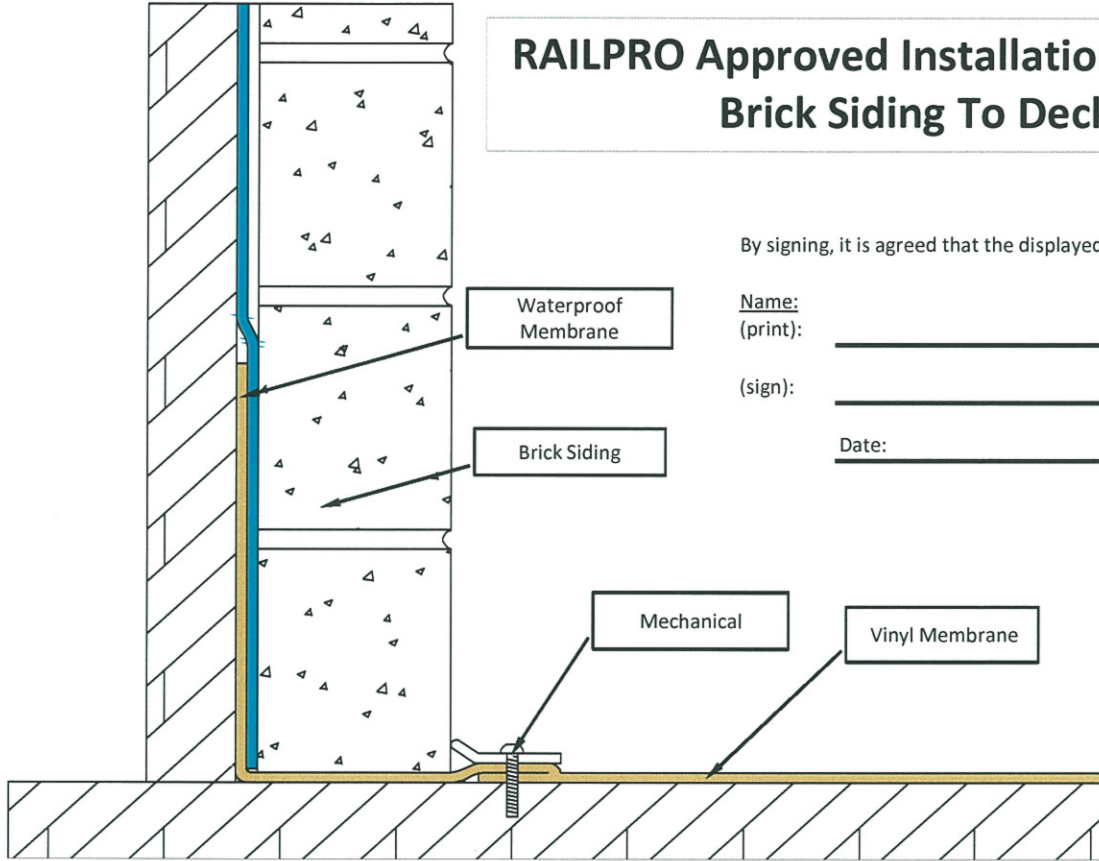

By signing, it is agreed that the displayed procedure will be performed as requested

Name: _____ Employee Witness: _____
 (print): _____ (print): _____
 (sign): _____ (sign): _____
 Date: _____



Vinyl spec. W/Tie in to existing deck	
Date: Sept 28/10	Drawn by: Kevin DiMarco
Created under RailPro Inc.	
Created for Internal purpose	
<u>Notes:</u>	

RailProApproved Installation Method For Use At Brick Siding To Deck Interface

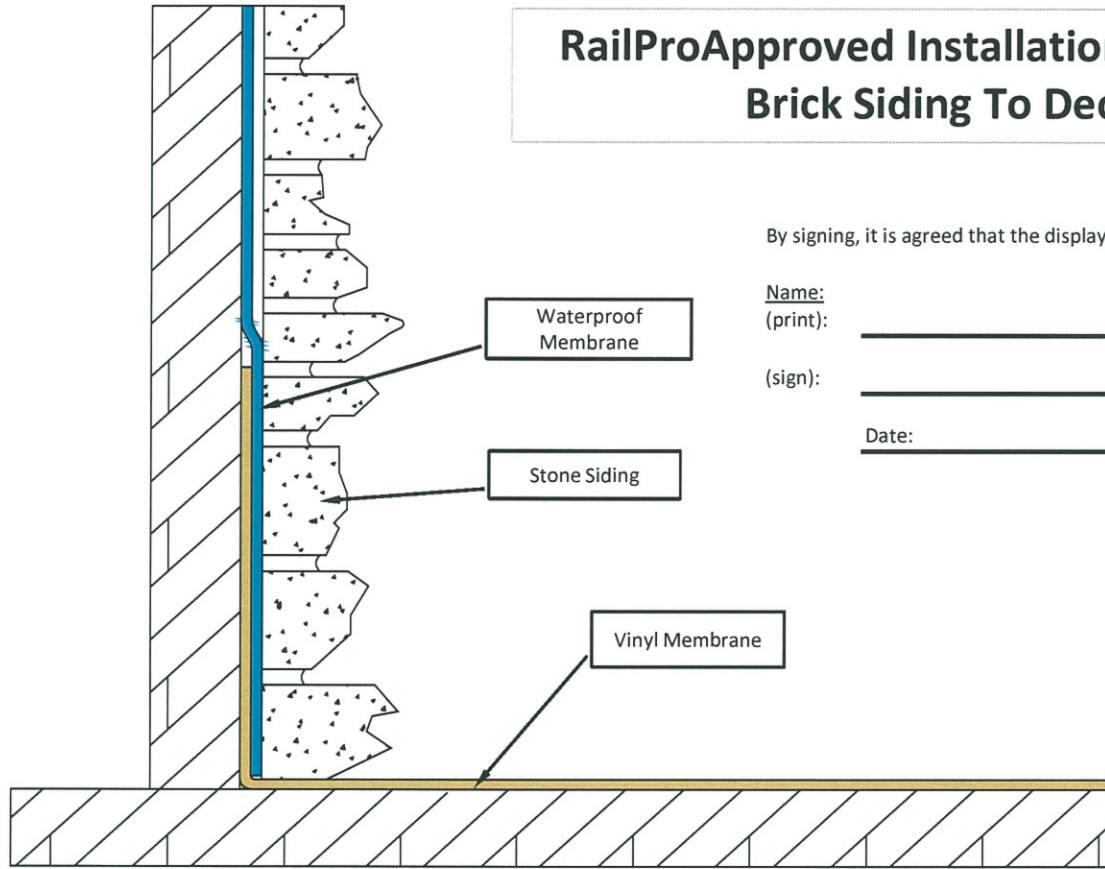

By signing, it is agreed that the displayed procedure will be performed as requested

Name: _____ Employee Witness: _____
 (print): _____ (print): _____
 (sign): _____ (sign): _____
 Date: _____



Vinyl spec.	
Date: Oct 12, 10	Drawn by: Kevin DiMarco
Created under RailPro Inc.	
Created for Internal purpose	
<u>Notes:</u>	

RailProApproved Installation Method For Use At Stone Siding To Deck Interface

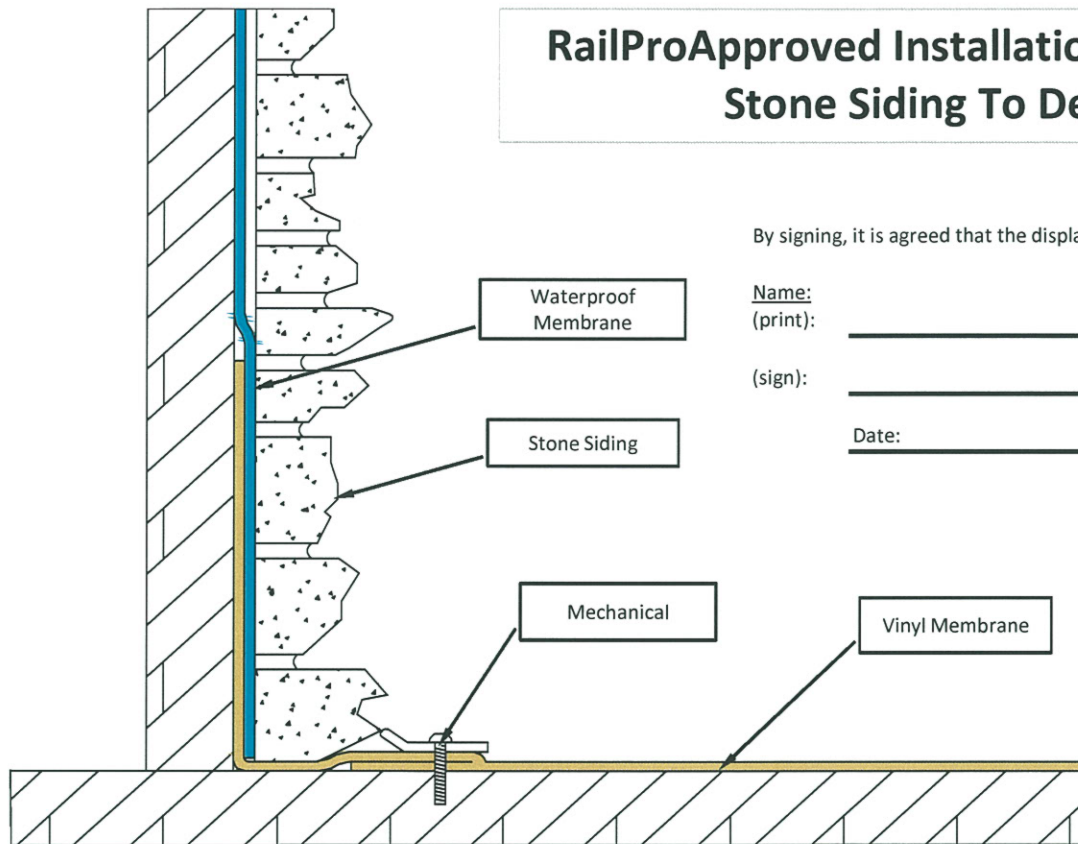

By signing, it is agreed that the displayed procedure will be performed as requested

Name: _____ Employee Witness: _____
 (print): _____ (print): _____
 (sign): _____ (sign): _____
 Date: _____



Vinyl spec. W/Tie in to existing deck	
Date: Oct 12, 10	Drawn by: Kevin DiMarco
Created under RailPro Inc.	
Created for Internal purpose	
<u>Notes:</u>	

Not Recommended Installation Method For Use At Brick Siding To Deck Interface

This Installation is not recommended by RailPro, nor is it an industry standard. It is not an approved waterproof finish. Rail Pro is unable to warranty any work using this procedure. By signing, it is agreed that the installation will be done without warranty.

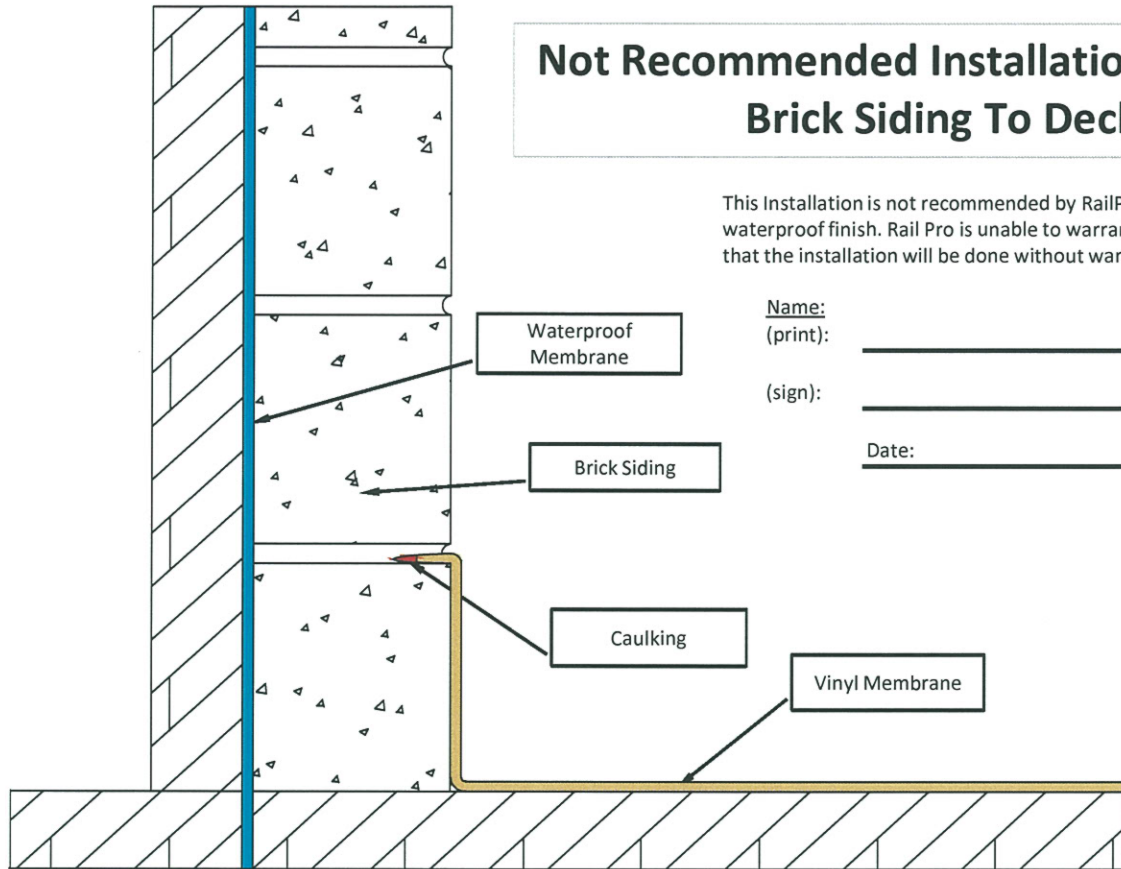

Name:

(print): _____

(sign): _____

Date: _____

Employee Witness:

(print): _____

(sign): _____



Vinyl spec. W/ Notched Brick

Date: Oct 12, 10 Drawn by: Kevin DiMarco

Created under RailPro Inc.

Created for Internal purpose

Notes:

Not Recommended Installation Method For Use At Brick Siding To Deck Interface

This Installation is not recommended by RailPro, nor is it an industry standard. It is not an approved waterproof finish. RailPro is unable to warranty any work using this procedure. By signing, it is agreed that the installation will be done without warranty.

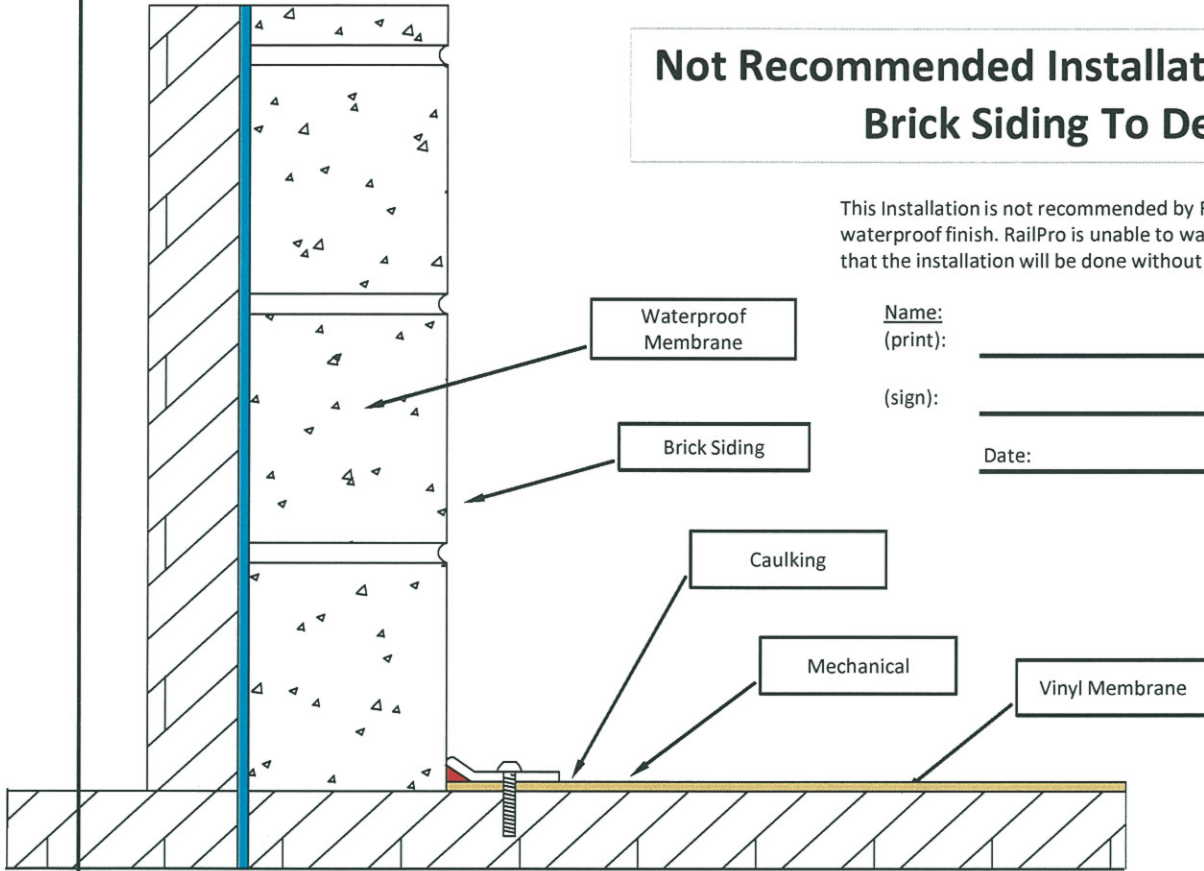

Name:
(print): _____

Employee Witness:
(print): _____

(sign): _____

(sign): _____

Date: _____



Vinyl spec. W/ Mechanical on deck

Date: Oct 12, 10 Drawn by: Kevin DiMarco

Created under RailPro Inc.

Created for Internal purpose

Notes:

Not Recommended Installation Method For Use At Brick Siding To Deck Interface

This installation is not recommended by RAILPRO, nor is it an industry standard. It is not an approved waterproof finish. RAILPRO is unable to warranty any work using this procedure. By signing, it is agreed that the installation will be done without warranty.

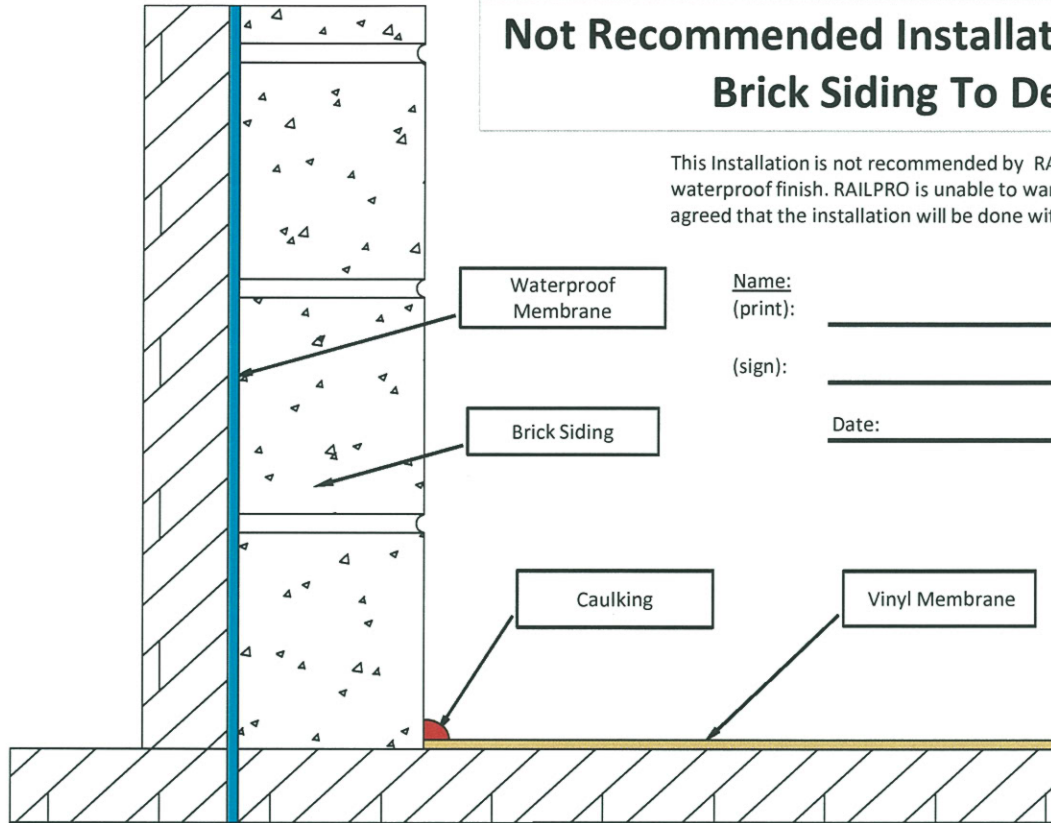

Name:
(print): _____

Employee Witness:
(print): _____

(sign): _____

(sign): _____

Date: _____



Vinyl spec. W/Caulking bead

Date: Sept 28,10 Drawn by: Kevin DiMarco

Created under RailPro Inc.

Created for Internal purpose

Notes:
